

Oaklands **Environmental Ltd**

Rainwater Harvesting Systems Grease Traps & Separators Oil & Fuel Tanks

PRODUCT BROCHURE 2024



Sewage Treatment Systems Water Storage Tanks Pumps & Accessories

www.oaklandsenvironmental.com



Moulding a Sustainable Future

INTRODUCTION

About us, product ranges.

WATER STORAGE TANKS

Water holding tanks, open top tanks, slimline tanks, heavy duty, below ground.....PAGE 1 - 4

RAINWATER HARVESTING

Slimline tanks, garden tanks.PAGE 5

RAINWATER HARVESTING

Rain Harvesting Tanks, Aquarius system, above and below ground, home and garden.....PAGE 6 - 8

OIL & FUEL TANKS

Bunded, single skin, waste oil.PAGE 9 - 10

CABIN EFFLUENT TANK

Waste water tank.....PAGE 11

SEWAGE TREATMENT

Modulus system, below ground.....PAGE 12 - 13

GREASE TREATMENT

GT, Jumbo, GS, grease trap, grease separator.....PAGE 15 - 16

SEPARATORS

Geoceptor, bypass separator, Silt Guardian, silt separator, Washceptor, washdown separator.....PAGE 17 - 19

PUMPING STATION

Pump station, pump chamber, Aquatrio filter.....PAGE 20

ACCESSORIES

Filter collector, valves, grommets, calmed inlet, lids, access covers, alarms.....PAGE 21 - 22

FILTERS

Rainwater filter, volume filter, submersible pumps.....PAGE 23

SPECIALISTS IN RAINWATER & WASTE WATER HARVESTING

Moulding a Sustainable Future

At Oaklands Environmental we are committed to developing products that will support the safe management of the environment, that's why we only use materials that can be recycled, when manufacturing our products.

Our systems are at the forefront of innovation and efficiency, in water/wastewater treatment products for domestic, commercial, agricultural and leisure sectors.

They are installed and specified by many major developers, leading designers and consultants across the UK and Europe.

Today, more than ever manufacturers need to provide totally sustainable products and systems that will support the increasing stress that is placed on the environment.

Our principal objective is to provide customers with efficient, manageable systems that are cost effective, whilst being simple to install and maintain.

It is of key importance, in this objective that we always use superior standard materials. Thus, ensuring the quality and reliability of our products.



WATER STORAGE



RAINWATER HARVESTING



OIL & FUEL TANKS



SEWAGE TREATMENT



GREASE TREATMENT



SEPARATORS



PUMPING STATIONS



ACCESSORIES



FILTERS

OUR RANGE
IS ALWAYS
GROWING
THROUGH
INVESTMENT

WATER STORAGE TANKS

Our water storage tanks are designed for use in a wide range of applications,. They are not only ideal for domestic bulk liquid storage, but also in various commercial and agricultural storage applications.

We manufacture our tanks from specially developed high quality polyethylene, making them extremely robust yet comparatively lightweight.
All design models in our range are one piece moulded for strength and reliability.

ABOVE GROUND TANKS



500 LITRE
HOLDING TANK



1,000 LITRE
HOLDING TANK



4,500 LITRE
HOLDING TANK

Holding Tank - Capacity Size	Dimensions mm	UV Stabilised
500 Litres	L; 1110 X W; 1000 X H; 750	✓
1,000 Litres	D; 1000 X H; 1200	✓
4,500 Litres	D; 2133 X H; 1219	✓

Our Slimline Tanks can be used either horizontally or vertically and are perfect for areas that are small or have limited space. Their space saving design makes these tanks versatile and able to used for varied applications.



200 LITRE
SLIMLINE TANK



400 LITRE
SLIMLINE TANK



500 LITRE
SLIMLINE TANK

Slimline Tank - Capacity Size	Dimensions mm	UV Stabilised
200 Litres	L; 920 X D; 325 X H; 800	✓
400 Litres	D; 340 X H; 1000 L: 1240	✓
500 Litres	D: 460 X H; 1010 X L: 1250	✓

Ideal for
mobile
valeting

- All of our Water Storage Tanks are potable
- Made from UV stabilised MDPE
- Available in a colour option of Blue, Black or Green
- Recyclable after use

WATER STORAGE TANKS

Our Eco range is a collection of attractive round, single skin water storage tanks. The range is suitable for the storage of potable and recycled water, above ground for many uses.

The tanks can be fitted with inserts for the added fitting of a tap outlet or adjoining pipework.

The largest range of water storage tanks in the UK

ECO TANKS



Eco Tank - Capacity Size	Dimensions mm	UV Stabilised
Eco 800 - 800 Litres	D: 1200 X H: 890	✓
Eco 1200 - 1,200 Litres	D: 1200 X H: 1260	✓
Eco 1600 - 1,600 Litres	D: 1220 X H: 1680	✓
Eco 2100 - 2,100 Litres	D: 1220 X H: 1950	✓
Eco 2500 - 2,500 Litres	D: 1220 X H: 2030	✓

- All of our Water Storage Tanks are potable
- Lightweight, rotational moulded HDPE construction
- Available in a colour option of Blue, Black or Green
- Recyclable after use

ABOVE GROUND TANKS

As well as the Eco Tanks, we have a wide range of above ground storage tanks in numerous capacity sizes, for light to heavy duty water storage. Designed to suit any application.

Model - Capacity	Dimensions mm Diameter X Height	UV Stabilised
Mini Tank - 228 Litres	D:630 x H:795	✓
OEPS1 - 350 Litres	D:630 x H:1275	✓
OE1209 -1150 Litres	D:1260 x H:1090	✓
OE1209e -1350 Litres	D:1260 x H: 1535	✓
OE1214 - 1550 Litres	D:1260 x H:1535	✓
OE1215 - 1850 Litres	D:1260 x H:1690	✓
OE1215e - 2150 Litres	D:1260 x H:2135	✓
OE1220 - 2250 Litres	D:1260 x H:2135	✓
OE1518 - 3400 Litres	D:1560 x H:1900	✓



WATER STORAGE TANKS

HEAVY DUTY TANKS

The compact designs of our Heavy Duty Tank range allows you to store a larger capacity of water for a longer time or for bulk usage, whilst taking up minimum space or eliminating the need for several smaller tanks.



OE2019

OE2021

5,000 LITRE

6,000 LITRE

8,000 LITRE

10,000 LITRE

Heavy Duty Tank - Capacity Size	Dimensions mm	UV Stabilised
OE2019 - 4,500 Litres	L; 2010 X W; 2070 X H; 1940	✓
OE2021 - 6,000 Litres	L; 2150 X W; 2210 X H: 2100	✓
5,000 Litres	D; 1900 X H; 2200	✓
6,000 Litres	D; 1900 X H; 2450	✓
8,000 Litres	D; 2490 X H; 1900	✓
10,000 Litres	D; 2490 X H; 2345	✓

Our specialist range of below ground tanks give you the option to store reusable water discretely, yet still allowing you access to it easily, when you need it.

The single piece moulded design ensures our tanks are sturdy, robust and reliable when in use in a variety of applications.

- All of our Water Storage Tanks are potable
- Lightweight, rotational moulded HDPE construction
- Available in a colour option of Blue, Black or Green
- Recyclable after use

BELOW GROUND TANKS

Model - Capacity	Dimensions mm Diameter X Height	UV Stabilised
Mini Tank - 228 Litres	D:630 x H:795	✓
OEPS1 - 350 Litres	D:630 x H:1275	✓
OE1209 -1150 Litres	D:1260 x H:1090	✓
OE1209e -1350 Litres	D:1260 x H: 1535	✓
OE1214 - 1550 Litres	D:1260 x H:1535	✓
OE1215 - 1850 Litres	D:1260 x H:1690	✓
OE1215e - 2150 Litres	D:1260 x H:2135	✓
OE1220 - 2250 Litres	D:1260 x H:2135	✓
OE1518 - 3400 Litres	D:1560 x H:1900	✓



MINI TANK

OEPS1

OE1209e

OE1209

OE1215

OE1214

OE1215e

OE1220

OE1518

Available with: 450mm man hole cover. 1"or 2" BSP threaded outlet. 110mm grommet seal top inlet/outlet.

WATER STORAGE TANKS

HEAVY DUTY BELOW GROUND

Our heavy duty, XL capacity, vertical water holding tanks are suitable for below ground installation and use. The one piece, moulded design will provide the strength and durability your underground tank will need to perform year after year. Ideal for bulk water containment in various applications. Comes with a lid/cover for easy inspection.



OE2019

Upto 6,000
Litres of
underground
water
storage !



OE2021

The OE2019 and OE2021 can be purchased with the options of 450mm diameter pedestrian duty lids and 215mm risers.

Uses include:

- General water storage
- Rainwater harvesting
- Pumping station

Available with:

- 350mm man hole cover.
- 1" or 2" BSP threaded outlet.
- 1" BSP threaded outlet.
- 100mm grommet seal top inlet/outlet.

SUITABLE FOR:

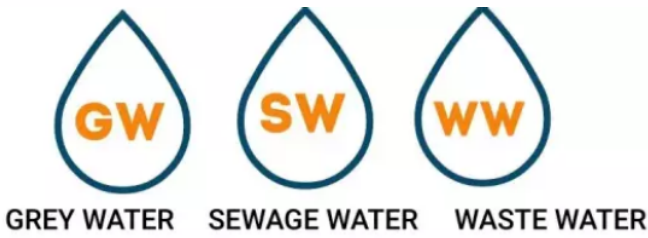

- All of our Water Storage Tanks are potable
- Lightweight, rotational moulded HDPE construction
- Available in a colour option of Blue, Black or Green
- Recyclable after use

HD Below Ground - Capacity Size	Dimensions mm	UV Stabilised
OE2019 - 4,500 Litres	L: 2010 x W: 2070 x H: 1940	✓
OE2021 - 6,000 Litres	L: 2210 x W: 2150 H: 2100	✓



Easy Installation



Aquatrio filter and adjoining pipework

RAINWATER HARVESTING

Rainwater harvesting is becoming a popular method of collecting and storing rainwater for use domestically.

A simple water butt or tank in the garden can collect enough rainwater to water a garden or wash the car over several months. Redirecting rainwater from a roof to a rainwater harvesting tank can be done above ground or below ground. Larger systems can be plumbed into existing pipework for using the water to wash clothes or flush a toilet.

ABOVE GROUND SYSTEMS



200 LITRE SLIMLINE TANK

Our space saving garden tank can be used vertically or horizontally. Ideally placed against a wall but can also be freestanding. Perfect for garden or greenhouse use.



400 LITRE SLIMLINE TANK

A versatile water holding tank, that will sit neatly against a wall or lie flat. Supplied with a filler/breather cap you have a choice of how you use the slimline tank.



500 LITRE SLIMLINE TANK

A larger capacity water tank. Can be used standing against a wall or flat on the ground. Supplied with a filler/breather cap.



- All of our Water Storage Tanks are potable
- Lightweight, rotational moulded HDPE construction
- Available in a colour option of Blue, Black or Green
- Recyclable after use

Our slimline tanks are supplied with a 1" outlet and a standard downpipe filter.

Slimline Tank - Capacity Size	Dimensions mm	UV Stabilised
200 Litres	L; 920 X D; 325 X H; 800	✓
400 Litres	D; 340 X H; 1000 L: 1240	✓
500 Litres	D: 460 X H; 1010 X L: 1250	✓

Rainwater harvesting can be produced from any kind of building, agricultural farming sheds & outbuildings, offices blocks, small restaurants & cafes, manufacturing warehouses or industrial units, as well as the humble family house.

A simple storage tank fitted to your stormwater drain collects falling rain from guttering and downpipes. A filter can be installed into our tanks, which removes leaves and other debris from rainwater before entering the tank. Water pumps can also be used to pump water troughs and water cisterns.

CALCULATION

Roof area (footprint) in square metres
X
annual rainfall in cubic metres.

(650ml = 0.65m³), divided by 12
=
average monthly rainfall capture.

EXAMPLE:
450m² x 750ml = 337.5 (m³),
divided by 12 = 28.125m³

or 28,125 litres per month on average.

HOW MUCH RAINWATER CAN YOU COLLECT ?

YOUR RAINWATER CALCULATION

It is important to ensure that the system you choose meets all of your requirements .

In general, in order to collect as much rainwater as possible we use this formula for an initial calculation.

We suggest storing an average of 2-3 months quantity of rainfall (keep in mind you may get 3 months) worth in your wettest month.

RAINWATER HARVESTING

RAIN HARVESTING TANKS - ABOVE GROUND

Water is becoming increasingly costly year on year. Rainwater Harvesting is fast becoming the norm when it comes to both saving money and precious water resources.

Households and property owners are continually finding ways of reusing rainwater for simple day to day uses like - watering the garden, washing the family car or cleaning windows.



Range
Capacities
800 - 10,000
litres

Talk to Us Today!



Tank Model	Capacity - Litres	Dimensions - Diameter x Height (mm)	Outlet Size - Inches	Accessories
OE800RS	800	D:1200 x H:890	1"	VF Filter, Overflow outlet pipe
OE1200RS	1200	D:1200 x H:1260	1"	VF Filter, Overflow outlet pipe
OE1600RS	1600	D:1220 x H:1680	1"	VF Filter, Overflow outlet pipe
OE2100RS	2100	D:1220 x H:1950	2"	VF Filter, Overflow outlet pipe
OE2500RS	2500	D:1200 x H:2030	2"	VF Filter, Overflow outlet pipe

about our
Rainharvesting Package
and get all of this ...

- Tank
- Calmed Inlet
- Overflow filter
- 2" Outlet
- Screw fit lid
- 110mm Inlet
- VF filter



Tank Model	Capacity - Litres	Dimensions - Diameter x Height (mm)	Outlet Size - Inches	Accessories
OE1518	3400	D:1560 x H:1900	2"	ZF Filter, Calmed Inlet Overflow outlet pipe
OE5000	5000	D:1900 x H:2200	2"	ZF Filter, Calmed Inlet Overflow outlet pipe
OE6000	6000	D:1900 x H:2450	2"	ZF Filter, Calmed Inlet Overflow outlet pipe
OE8000	8000	D:2490 x H:1900	2"	ZF Filter, Calmed Inlet Overflow outlet pipe
OE10000	10,000	D:2490 x H:2345	2"	ZF Filter, Calmed Inlet Overflow outlet pipe

OPTIONAL EXTRAS AVAILABLE
FOR ALL TANK MODELS

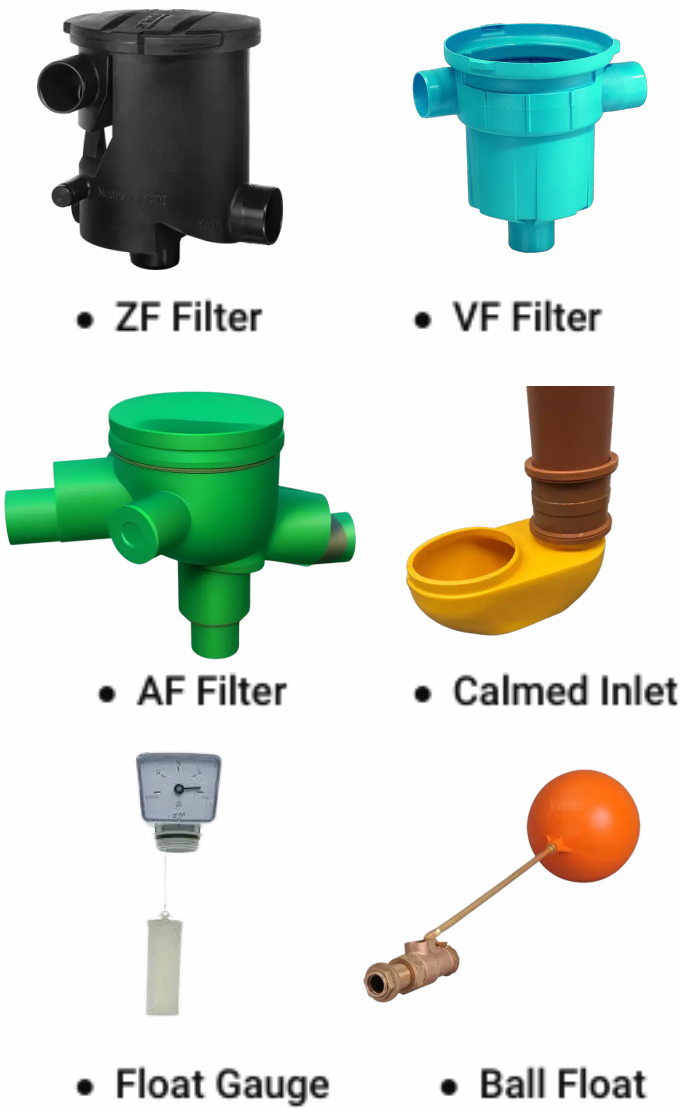

- Lightweight, rotational moulded HDPE construction
- Available in a colour option of Blue, Black or Green
- Recyclable after use

RAINWATER HARVESTING

AQUARIUS RAIN HARVESTING SYSTEM

The Aquarius Rain Harvesting Systems could help you to effectively replace up to 50% of the daily domestic potable water use with harvested rainwater and up to 85% of non domestic water use dependant on the amount of rainfall and the storage volume.

The UK daily average potable water usage per household is 150 litres per person. Over 50% of that water consumption is used on flushing toilets, laundry and for outdoor use in gardening and car wash applications.

In such applications potable water does not need to be used.

Find Out More ↓

Range
Capacities
1250 - 5700
litres



OUR AQUARIUS SYSTEM IS AVAILABLE IN 2 RANGES

GARDEN SYSTEM

- For use in garden irrigation, sprinkler systems and washing vehicles.
- Includes primary leaf and debris filter
- Mains powered pump
- Secondary pump filter
- Above and below ground installations
- Quality HDPE tank c/w lockable cover
- Suitable for existing and new developments
- Power is supplied by a standard mains socket
- Units are supplied with 15 metres of cable

ABOVE GROUND UNIT

Standard downpipe filter



HOME SYSTEM

- For self build, new and existing residential properties.
- Automatic operation with top-up controller
- Can reduce water consumption by up to 50%
- Non-potable applications such as toilet flushing and washing machines
- Direct feed to w.c. under mains pressure
- Overflow c/w vermin grill
- Internal primary ZF leaf and debris filter for roof areas up to 150 m2
- External primary VF leaf and debris filter for roof areas up to 350 m2
- Secondary floating intake filter
- Calmed inlet for improved aeration

BELOW GROUND UNIT



Oaklands Environmental can offer informed, up to the minute advice, along with a consultancy service.

This ensures that the system we prescribe will be of the highest quality and totally sustainable.

RAINWATER HARVESTING

AQUARIUS BELOW GROUND RAINHARVESTING SYSTEM

PRODUCT OVERVIEW

The Aquarius Below Ground Rainharvesting Systems can provide 1150 - 6000 litres of descreet, below ground water storage. Supplied with an internal debris filter which is easily accessed via a removal steel cover (also included). Powered by a 240v, 900w submersible float pump, with a max flow rate of up to 6 m3/h. The pump also has an auto float switch feature. The Aquarius System tank head is home to a uniquely designed 3 inlet/outlet and overflow intersection accomodating 110 or 160mm pipework and filter separately, allowing for maximum tank capacity.



SPECIFICATIONS

MODEL	CAPACITY - LITRES	DIAMETER - MM (LENGTH 2021 MODEL)	HEIGHT - MM	WIDTH - MM	INLET OPTIONS - MM	OUTLET OPTION - MM	INCLUDED FEATURES
AQUARIUS 1209	1150	1260	1800	N/A	110/160	110/160	240v ELECTRIC FLOAT PUMP
AQUARIUS 1215	1850	1260	2350	N/A	110/160	110/160	240v ELECTRIC FLOAT PUMP
AQUARIUS 1518	3400	1560	2500	N/A	110/160	110/160	240v ELECTRIC FLOAT PUMP
AQUARIUS 2021	6000	2210	2750	2150	110/160	110/160	240v ELECTRIC FLOAT PUMP

FEATURES

- Lightweight rotational moulded HDPE tank
- Unique spacesaving inlet/outlet pipework head
- Easy filter access for cleaning and maintenance
- 3 Inlet option points
- Inlet size options - 110 or 160mm
- Outlet point
- Overflow outlet point
- Complete with steel cover and 240v electric water pump
- Recyclable after working lifespan *

OIL & FUEL TANKS

The newest tanks in our range are the Oil & Fuel Storage Tanks collection. Offering both single skinned and bunded versions, available in several different design specifications from the standard round tank design to slimline versions from 800 litre to 2500 litre capacities.

All storage tanks have been manufactured from a specially developed, premium quality virgin polymer, high density polyethylene in accordance to technical, environmental and regulatory requirements

BUNDED TANKS



OE800RB

OE1200RB

OE1600RB

OE650SB

The smallest tank in our range allows for discreet oil or fuel storage without taking up too much ground space. Unobstrusive look & design.

This medium size tank is ideal for convenient and safe oil or fuel storage. Designed to be unobstrusive yet, practical.

The generously sized tank allows for a greater storage volume whilst occupying minimum floor space. A popular choice of tank.

Our slimline oil tank range has been designed to be installed in areas where space is limited. Its compact design means the tank will fit unobtrusively and securely into position.

WHY DO I NEED A BUNDED TANK ?

A bund (a tank within a tank) prevents fuel lose. Environmental regulations state that secondary bunding is required if oil or fuel storage falls within a 10m distance of a watercourse or within 50m of a potable water supply.

A bunded tank gives you extra protection against any fuel leakage, containing any spills or leaks within the outer tank bund, preventing loss or contamination.



OIL & FUEL TANKS

Tank Range - Bunded	Litres	Dimensions: D x H mm	Weight KG	Tank Ref	Outlet Thread
Round Bunded	800	1400 x 1190	70	OE800RB	1" BSP
Round Bunded	1200	1400 x 1540	80	OE1200RB	1" BSP
Round Bunded	1600	1400 x 1890	102	OE1600RB	1" BSP

WASTE OIL TANKS

Tank Range - Bunded	Litres	Dimensions: D x H mm	Weight KG	Tank Ref	Outlet Thread
Waste Oil Bunded	800	1400 x 1190	70	OE800WB	1" BSP
Waste Oil Bunded	1200	1400 x 1540	80	OE1200WB	1" BSP
Waste Oil Bunded	1600	1400 x 1890	102	OE1600WB	1" BSP

OIL & FUEL TANKS

SINGLE SKIN TANKS

Our single skin Oil Tanks are ideal for most domestic installations.

We recommend our tanks are installed in accordance with Environmental regulations or within an existing reinforced concrete or masonry bund.

Our tanks are manufactured from prime High Density Polyethelene and are UV stabilised, to ensure a reliable, long life product.



ROUND SINGLE SKIN TANKS

Tank Range - Round Single Skin	Litres	Dimensions DIA x H mm	Weight KG
OE800RS	800	1200 x 890	28
OE1200RS	1200	1220 x 1260	37
OE1600RS	1600	1220 x 1680	46
OE2000RS	2000	1200 x 2030	55
OE2500RS	2500	1400 x 1950	65



SLIMLINE SINGLE SKIN TANKS

Tank Range - Slimline Single Skin	Litres	Dimensions L x D x H mm	Weight KG
OE650SS	650	1500 x 520 x 1100	68
OE1100SS	1100	1700 x 672 x 1250	80
OE2100SS	2100	1950 x 830 x 1400	92

CABIN EFFLUENT TANK

The Cabin Tank has been designed to meet the needs of the portable sanitation industry. Its low profile design allows it to be positioned alongside or underneath portable site accomodation, toilet blocks, kitchens, canteens and welfare units.

Features

- High quality, lightweight, corrosion free polyethylene construction
- Designed to fit beneath portable cabins without access to on site drainage or mains effluent discharge
- 2500 Litre waste effluent storage capacity
- 2 Large sealed lids for easy cleaning and emptying
- 4 Coated steel carryng handles for ease of use
- Optional wireless level indicator and interlinking tank kits

Multiple tanks can be linked together using additonal pipework to create a larger capacity system for increased or high volume usage. Making it ideal for festivals and outdoor events.

The Cabin Effluent Tank is intended for above ground use only

SUITABLE FOR:

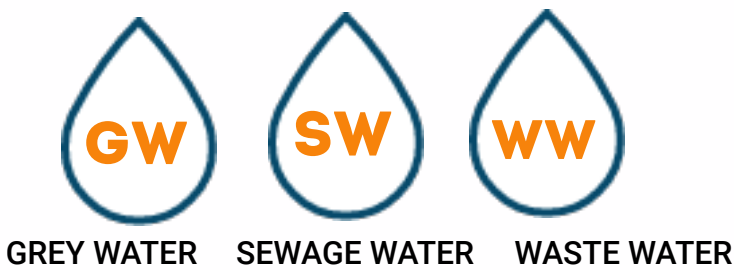

Range/Model	Capacity - Litres	Dimensions: H x D x L mm	Weight: Empty/ Full - Kgs	Colour Option
Cabin Effluent Tank	2500	450 x 2400 x 2800	110 - 2610	Yellow, Blue, Green, Black, Red, Grey

PLAN VIEW

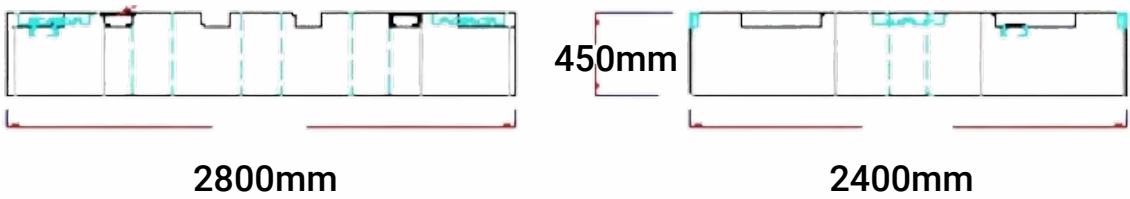
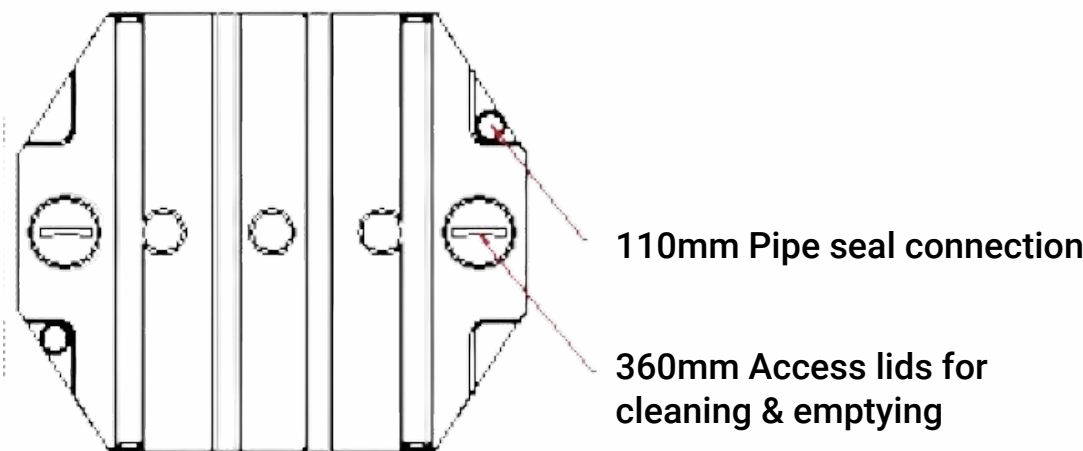

SIDE VIEW

FRONT VIEW

- Transport & Handling - Can be lifted using carrying handles by crane/chain or by forklift
- Siting - Position on a flat level surface, free from debris
- Storage - Can be stored when empty vertically (recommended) or horizontally up to 3 units high

SEWAGE TREATMENT

MODULUS SYSTEM

Our Modulus Sewage Treatment systems are designed and manufactured to be capable of taking care of effluent of cities and towns.

The Modulus is ideally suited to serve a range of applications from small domestic residences to small communities and commercial properties.

The Modulus system is at the forefront of pioneering design with low cost ownership and maintenance



Independently tested at the CERIB test facility in France to meet the requirements of EN 12566:3.

OUR MODULUS SYSTEM IS AVAILABLE IN 8 SIZES



OM6LP

Population Eqv 6

A low -profile design, modular system based on a proven traditional 3-chamber design.
It can be installed in a variety of footprints giving it great versatility and flexibility.
Optional configuration to suit footprint

Gravity and pumped discharge options
3-stage process employing submerged and biological aerated filter (SAF/BAF) technology

Includes blower unit, housing and pedestrian rated inspection covers



OM6

Population Eqv 6

A modular system based on a proven traditional 3-chamber design.
It can be installed in a variety of footprints giving it great versatility and flexibility.
Optional configuration to suit footprint

Gravity and pumped discharge options
3-stage process employing submerged and biological aerated filter (SAF/BAF) technology

Includes blower unit, housing and pedestrian rated inspection covers



OM9

Population Eqv 9

A modular system based on a proven traditional 3-chamber design.
It can be installed in a variety of footprints giving it great versatility and flexibility.
Optional configuration to suit footprint

Gravity and pumped discharge options
3-stage process employing submerged and biological aerated filter (SAF/BAF) technology

Includes blower unit, housing and pedestrian rated inspection covers

Modulus Model	Hydraulic Flow - litres per day	Dimensions: H x W x L	Inlet/Invert
OM6LP (low profile)	1080	1060 x 1260 x 4180	350
OM6	1080	1535 x 1260 x 4180	500
OM9	1620	1535 x 1260 x 4180	500

- Lightweight, rotational moulded HDPE construction
- Available in a colour option of Blue, Black or Green
- Recyclable after use

SEWAGE TREATMENT

MODULUS SYSTEMS



OM12

Population Eqv 12

A modular system based on a proven traditional 3-chamber design. It can be installed in a variety of footprints giving it great versatility and flexibility.
Optional configuration to suit footprint
Gravity and pumped discharge options
3-stage process employing submerged and biological aerated filter (SAF/BAF) technology

Includes blower unit, housing and pedestrian rated inspection covers

OM40/50

Population Eqv 40 /50

A modular system based on a proven traditional 3-chamber design. It can be installed in a variety of footprints giving it great versatility and flexibility.
Optional configuration to suit footprint
Gravity and pumped discharge options
3-stage process employing submerged and biological aerated filter (SAF/BAF) technology

Includes blower unit, housing and pedestrian rated inspection covers



OM20

Population Eqv 20

A modular system based on a proven traditional 3-chamber design. It can be installed in a variety of footprints giving it great versatility and flexibility.
Optional configuration to suit footprint
Gravity and pumped discharge options
3-stage process employing submerged and biological aerated filter (SAF/BAF) technology

Includes blower unit, housing and pedestrian rated inspection covers



OM25

Population Eqv 25

A modular system based on a proven traditional 3-chamber design. It can be installed in a variety of footprints giving it great versatility and flexibility.
Optional configuration to suit footprint
Gravity and pumped discharge options
3-stage process employing submerged and biological aerated filter (SAF/BAF) technology

Includes blower unit, housing and pedestrian rated inspection covers

OM30 - Population Eqv 30 also available in the same model.



OM50

Modulus Model	Population Equiv	Hydraulic Flow - litres per day	Dimensions: H x W x L	Inlet/Invert
OM12	12	2160	1920 x 1260 x 4180	500
OM20	20	3600	2135 x 1260 x 4180	500
OM25	25	4500	2130 x 1560 x 5080	500
OM30	30	5400	1920 x 1260 x 4680	500
OM35	35	6300	2130 x 1560 x 5080	500
OM40	40	7200	1940 x 2010 x 6210	500
OM50	50	9000	2100 x 2150 x 7000	500

GREASE TREATMENT

OUR RANGE OF SYSTEMS CATER FOR ALL SIZES OF CATERING ESTABLISHMENTS AND APPLICATIONS

A grease treatment system should be installed by catering establishments and food processing facilities to help and support the drainage system. Our systems help to prevent the build up of fats, oils and grease known - as F.O.G's solidifying and blocking drainage systems. The installation of a grease trap is a proven method of preventing excess grease entering the drainage system. It is particularly important for businesses that regularly serve more than 30 meals per day.

For larger applications, serving 600+ meals per day we recommend installing a grease separator.

GT & JUMBO SYSTEMS

Designed for the separation and retention of FOG's in kitchens and standard catering establishments.



GT1

The GT1 is the smallest unit in our range and is suitable for applications up to 150 covers per day. Includes access/inspection cover Unique hollow baffle and step design assists separation and retention

Material : Polyethylene, HDPE



JUMBO 1

The J1 a medium size unit and is suitable for applications up to 300 covers per day. Includes access/inspection cover Unique hollow baffle and step design assists separation and retention

Material : Polyethylene, HDPE



JUMBO 2

The J2 is a popular size unit and is suitable for applications up to 600 covers per day. Includes access/inspection cover Unique hollow baffle and step design assists separation and retention

Material : Polyethylene, HDPE

Range/Model	Covers per day	Sludge capacity ltrs	Std pipe size	Height inc cover	Width/Diameter	Length	Inlet/Invert
GT1	150	100	100	595	600	750	190
GT2	300	180	100	595	600	1580	190
Jumbo J1	300	180	100	820	720	1100	260
Jumbo J2	600	350	100	820	720	2280	260

- GT1 - Our smallest grease trap caters for up to 150 covers per day
- Jumbo - 300 & 600 litre grease traps cater for 300 to 600 covers per day

IMPORTANT INFO

These products will require regular inspection and maintenance including the removal of accumulated controlled waste for environmental disposal by registered waste carriers as per Environment Agency guidelines.

GREASE TREATMENT

Designed for the separation and retention of FOG's in kitchens and catering establishments.

The GS range of grease separators provides a large volume of liquid to slow down the flow of hot greasy water. This extended retention time permits suspended FOG's to cool and separate, floating to form a waste layer at the surface. Larger solid particles sink and settle to form a sludge layer in the base of the unit

GS SYSTEM



GS1

The GS1 is designed for larger catering and processing facilities eg: hotels and abattoirs, and is suitable for applications up to 1150 covers per day.

Includes access/inspection cover
Settles high density solids

Material : Polyethylene, HDPE



GS2

The GS2 is a popular choice in this range and is suitable for applications up to 1900 covers per day.

Includes access/inspection cover

Unique hollow baffle and step design assists separation and retention

Material : Polyethylene, HDPE



GS3

The GS3 is a larger unit and is suitable for applications up to 2750 covers per day. Includes access/inspection cover.

Designed for larger catering and meat processing facilities, e.g. hotels and abattoirs

Material : Polyethylene, HDPE

Range/Model	Covers per day	Sludge capacity ltrs	Std pipe size	Height inc cover	Width/Diameter	Length	Inlet/Invert
GS1	1150	600	100	1520	1260	1260	450
GS2	1900	1000	100	2100	1260	1260	450
GS3	2750	1800	100	2130	1560	1560	500

• GS Range - Separators for larger applications over 600 covers

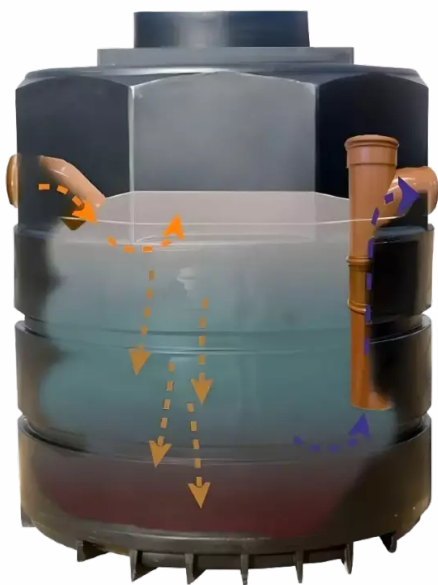

OPERATING CHARACTERISTICS

Suspended FOG's Solids & heavier waste Cleaner water

IMPORTANT INFO

These products will require regular inspection and maintenance including the removal of accumulated controlled waste for environmental disposal by registered waste carriers as per Environment Agency guidelines.

GREASE TREATMENT SYSTEMS

GS SYSTEM



GS3.5

The GS3.5 unit has a larger capacity and is suitable for applications up to 3900 covers per day.

Designed for larger catering and meat processing facilities, e.g. hotels and abattoirs

Includes access/inspection cover
Material : Polyethylene, HDPE



GS4

The GS4 is the largest unit in our range and is suitable for applications up to 5500 covers per day.

Designed for larger catering and meat processing facilities, e.g. hotels and abattoirs

Includes access/inspection cover
Material : Polyethylene, HDPE

SPECIFICATIONS

All measurements are in mm, unless otherwise stated.

Range/Model	Covers per day	Sludge capacity ltrs	Stnd pipe size	Height inc cover	Width/Diameter	Length	Inlet/Invert
GS3.5	3200	2010	100	1940	2010	2070	450
GS4	5500	3000	100	2150	2150	2200	450

• GS Range - Separators for larger applications over 600 covers

- Lightweight rotational moulded HDPE construction
- Designed for larger catering and meat processing facilities eg: hotels and abattoirs
- Separates and retains Fats, Oils and Greases (FOG's)
- Settles high density solids
- Promotes clean and free running drains
- Conventional connections to 110mm and 160mm pipework

The GS range of separators are designed for containment and NOT treatment.

OPTIONAL EXTRAS

Our GS systems are available with optional accessories:

- Lockable access cover
- Extension risers

IMPORTANT INFO

These products will require regular inspection and maintenance including the removal of accumulated controlled waste for environmental disposal by registered waste carriers as per Environment Agency guidelines.



SEPARATORS

Our separator range has been designed to separate hydrocarbons and silts from surface water in drainage areas and retaining them for removal when required.

Designed and manufactured from polyethylene to be compact and lightweight, our systems are versatile and can be used for multiple purposes.

The ranges include Bypass Separators, Silt Separators and Vehicle Wash Separators.

Bypass Separator

NSB 3.5 - 18

The Geoeptor range has been designed to separate hydrocarbons and silts from surface water with a drainage area of up to 10,000 sqm.

Independently tested over an 18 month period at a leading European testing facility, the Geoeptor complies with EN 858 1-2. Proven to remove hydrocarbons from surface water to less than 1 mg/litre.

Very compact and lightweight the range is manufactured from polyethylene, making it robust and safe. The filter system located in the top section of the unit, can be removed for cleaning or replaced within minutes helping you to make savings on maintenance costs.

Available in 8 sizes.

Material: Polyethylene, HDPE

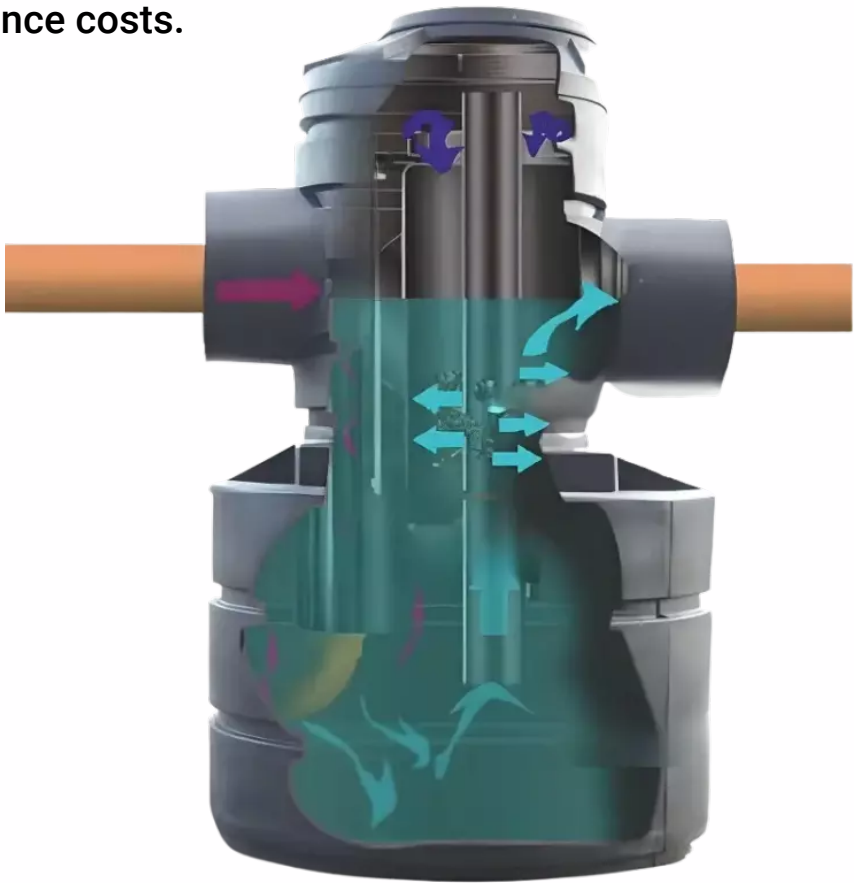

Contaminated flow:
Hydrocarbon effluent

Separation path
of water

Bypass / Overflow

8 Sizes
Available in
Range

Range/Model Geoeptor	Nominal Size mm	Drainage Sqm	HC Retention Ltrs	Dimensions: H x D mm	Inlet/Invert 1 10/160 pipework	Inlet/Invert 225/300/375/450
NSB 3.5	3.5	1944	52.5	1965 x 1260	625	650/685/720/760
NSB 4.5	4.5	2500	67.5	1965 x 1260	625	650/685/720/760
NSB 6	6	3333	90	1965 x 1260	625	650/685/720/760
NSB 8	8	4444	120	1965 x 1260	625	650/685/720/760
NSB 10	10	5555	150	2550 x 1260	625	650/685/720/760
NSB 12.5	12.5	6940	187.5	2550 x 1260	625	650/685/720/760
NSB 15	15	8333	225	2500 x 1260	625	650/685/720/760
NSB 18	18	10000	270	2800 x 1560	625	650/685/720/760

• HC - Hydrocarbon

SEPARATORS

Designed to intercept silt and solids upstream of Rainwater Harvesting and Flood Management systems the Silt Guardian is equally at home in vehicle wash applications. The Silt Guardian is equipped with a lightweight foam filter that will prevent particles greater than 0.3mm from passing downstream, retaining them in the chamber for removal when required. The filter cartridge has an overflow channel in the event that the filter blinds, however fitting the optional Silt Level Monitor will alleviate this by alarming when silt reaches a maximum level.

SILT GUARDIAN



• SG 1 - Diagram showing silt retention process.

- Lightweight rotational moulded HDPE construction
- Three inlet orientations
- 160mm to 450mm standard connections
- 450mm risers available as an optional extra
- Easily accessed filter cartridge for maintenance
- Optional silt level monitor alarm

SG 1-4

The Silt Guardian is the sister of the accredited Geoeceptor bypass separator.

It utilises particular aspects of the Geoeceptor design to intercept silt and solids upstream of storm attenuation systems.

The Silt Guardian is also equally at home in vehicle wash applications where its design gives improved results in removing silt and lighter solids from wash down areas.

Specifications and dimensions are listed in the below table.

Available in 4 sizes.

Material: Polyethylene, HDPE



• SG4 Model

SPECIFICATIONS

All measurements are in mm, unless otherwise stated.

Range/Model - Silt Guardian	Silt Retention Ltrs	Drainage Sqm	Dimensions: H x D x L	Inlet/Invert 110/160 Pipework	Inlet/Invert 225/300/375/450
SG1	1000	5500	1965 x 1260 x N/A	625	650/685/720/760
SG2	1800	10000	2550 x 1260 x N/A	625	650/685/720/760
SG3	3000	16500	2800 x 1560 x N/A	625	650/685/720/760
SG4	5500	30500	3050 x 2150 2200	625	650/685/720/760

Please Note:
The waste separated from vehicle washing and cleaning businesses can be classified as 'contaminated waste'. As such there is a duty of care to dispose/recycle this waste responsibly through a registered waste carrier to a suitably licensed facility.

SEPARATORS

WASHCEPTOR

The Washceptor range is predominantly used in vehicle wash down areas or jet wash bays to separate detergents or silt and dirt and prevent them from being discharged into the drainage system.

Washdown Separator

WVWS 1000 - 10,000

The Washceptor range is predominantly used in vehicle wash down areas or jet wash bays to separate detergents or silt and dirt and prevent them from being discharged into the drainage system.

The Washceptor comes in 5 capacity sizes:

1000, 2000, 3000, 5000, 10,000 litres (8 model options)

Each unit comes as a single, two or three stage option to suit the required application. Multi stage units are delivered as separate chambers.

All Washceptors produce Class 2 discharge levels and must discharge to a foul drain.

Material: Polyethylene, HDPE

- Lightweight rotational moulded HDPE construction
- Separates and retains sediment, silt and hydrocarbons from washdown areas
- Single and multistage units available to optimise performance per application
- Easy access for emptying and cleaning
- Ideal for tool hire depots, car and pressure washers, sportsground equipment wash facilities, fleet maintenance and valeting

5 Sizes
Available in
Range

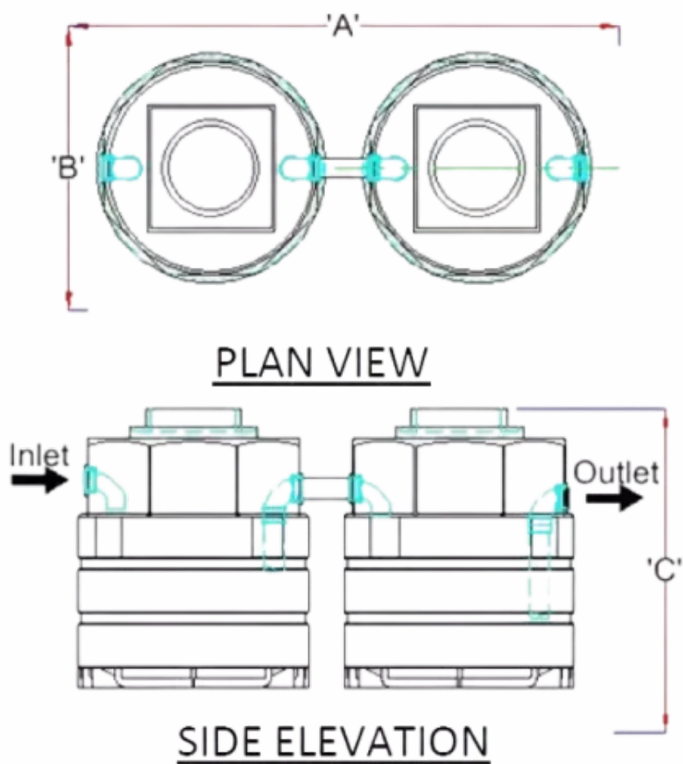

Range/Model Washceptor	Flowrate	Vehicles/Hour (approx)	Nominal Capacity	Footprint (allowing for backfill) L x W x D mm	Model Ref
Single Jetwash/handwash	10L/min	4	1000 litres	1560 x 1560 x 1785	W1S12
				2010 x 910 x 1650	W2S12
Commercial Carwash	20L/min	8	2000 litres	3020 x 1560 x 1785	W2S24
			3000 litres	4480 x 1560 x 1785	W3S36
Brush wash	50L/min	12	5000 litres	4480 x 1560 x 2385	W3S60
				2710 x 2650 x 2350	W1S60
Gantry/truck wash	100L/min	Commercial vehicles/coaches	10,000 litres	7110 x 2510 x 2210	W3S120
				5120 x 2650 x 2350	W2S120

Please Note

The waste separated from vehicle washing and cleaning businesses can be classified as 'contaminated waste'. As such there is a duty of care to dispose/recycle this waste responsibly through a registered waste carrier to a suitably licensed facility.

PUMP STATIONS

A pumping station is used to raise and distribute sewage or wastewater when gravity will not naturally disperse it.

We can provide a full range of pump stations for either stormwater or wastewater applications supplied in a HDPE chamber or tank.

PUMP CHAMBER

Pump chambers can be supplied separately either unfitted or partially fitted, with or without inlet pipe work and access covers.

Volumes from 300 litres upwards are available in varying diameters with optional manway sizes offering easy access for servicing and maintenance.

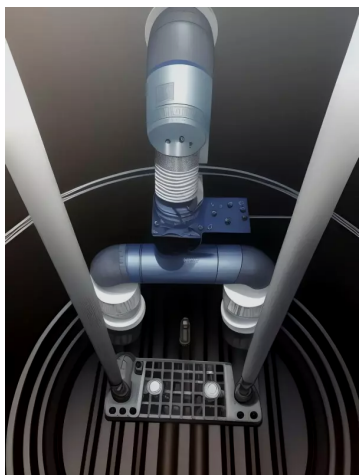

Pipe work example



Tank cutaway internal diagram

AQUATRIO



Simple filter removal

AQUATRIO FILTER

Independently tested at Newcastle University, the Aquatrio achieved an average 98% flow efficiency rate up to 5 litres a second.

The Aquatrio's proven performance makes it suitable for all domestic applications as well as industrial, commercial and agricultural applications requiring primary filtration for higher flows.

The large 220mm circular stainless steel filter located in the centre of the three inlets with a 15° fall to the flow, this facilitates the Aquatrio's self flushing process.

• measurements in mm

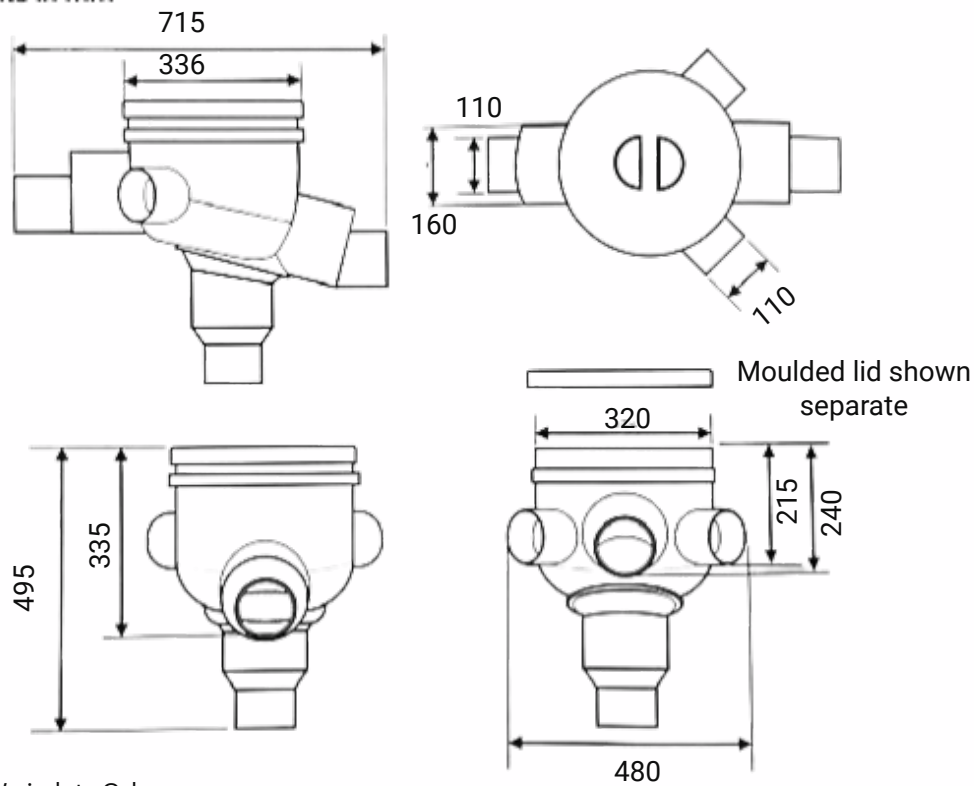

Technical Data Weight: 3 kg
Material: HDPE, Stainless Steel
Access Cover: HDPE Lightweight
Optional: 100mm 45° bends pipe connections,
Cast or Steel Cover

ACCESSORIES

FILTER COLLECTOR

The Rainwater Filter Collector can connect to any storage tank or water butt using a universal link kit. Attached to the down pipe the Filter Collector directs cleaned water to the storage tank whilst dirty water and debris travel down the down pipe to the sewer. By removing leaves the filter reduces the risk of disease carry-over. It also removes sludge leading to reduced algae in the storage tank/water butt.



- Filter unit fits ALL UK down pipes from 65 mm – 110 mm (round and square)
- Once tank is full, filter acts as overflow outlet
- Compatible with all water butts when using a Universal Link Kit
- Filter cartridge easily removable for cleaning
- Designed for roof sizes up to a maximum of 90 sq metres
- Outlet adapter fits 1 ¼" and 2" hosepipes.
- Volumes from 300 litres upwards are available in varying diameters with optional manway sizes offering easy access for servicing and maintenance.

THREAD BALL VALVE - FEMALE TO FEMALE

- Valve type: Ball
- First end type: Female BSP thread
- First end size: 1 ¼" (32 mm nominal bore)
- Second end type: Female BSP thread
- Second end size: 1 ¼" (32 mm nominal bore)
- Material type: PVC (Polyvinyl chloride)



THREAD BALL VALVE - STAINLESS STEEL

- Available in BSP or NPT, sizes: 1/4" to 2".
- Temperature range: -20°C to +180°C.
- Operating pressure: 1000 PSI WOG.
- Movement: 90° turn
- Material: Stainless steel

110MM RUBBER WALL SEAL GROMMET

Rubber wall seal sump grommets in 110mm diameter.

Our sump chambers all come with seals as standard but occasionally , additional inlets or outlets are required in which case, spare seals will need to be ordered.

Suitable for both ground water and foul waste pump stations.



CALMED INLET

Calmed inlets are designed to prevent water from becoming stained and odorous, and avoid disturbing sediment at the bottom of the tank ensuring the best possible water quality.

As the water flows through the calmed inlet, its velocity is reduced to allow it to enter the tank without turbulence; Calmed rainwater entering the tank supplies oxygen to the water resting at the lower end, keeping it fresh by prevention of anaerobic decomposition.

ACCESSORIES

12 INCH LID & COLLAR

- 12" tank-mounted collar / ring.
- Fastens to water or waste tank.
- In combination with a 12" tank lid, used to seal water and waste tanks
- Weight: 780g



INSPECTION CHAMBER COVER & FRAME

- Use with below ground tanks and systems
- 450mm round plastic inspection chamber cover
- Manufactured from high quality black polypropylene
- Ideal for light use, outdoors
- Cover screws down to the frame to secure it into place
- Weight: 4.5 kg

SEPARATOR ALARM

The mains powered interceptor alarm system with three probe sensors is installed within the separator to automatically detect the levels of oil, silt and liquid within. If excessive levels are reached the alarm activates a claxon or beacon to provide an audible or visual notification of excessive liquid levels.

The alarm system and sensors guarantee an increased level of safety and requires simple installation for bespoke monitoring of oil and petrol separators.



- Warn of excessive levels of oil, liquid and silt
- Tells you when separator needs emptying
- Reduces waste management costs
- Designed to comply with EN858-1&2 and PPG3
- Can be fitted to interceptors from all manufacturers
- Reduces interceptor servicing costs
- Automated and remote monitoring
- Ensures safe and economic operation of interceptors. 2.2 kg

Technical Data

Mains Powered: 230V AC
 IP65 ABS Enclosure: 180 x 180 x 60mm
 Output: Clean Contact Relay
 Display: Liquid Crystal
 Alarm: Audible (local)
 Beeper Sound: Maximum 80dB at 10cm (will be significantly less in a sealed enclosure)
 Probe Range: 200 metres max. (dependent on cable style)

OIL & EFFLUENT TANK ALARM

The Apollo ultrasonic oil tank monitoring system enables the tank oil level to be checked remotely. The lithium (CR2430 supplied) battery operated transmitter fits plastic or steel tanks up to 3 metres high and transmits up to 200 m to the receiver, which will auto-reset after a power failure. The transmitter fits a 20 or 32 mm diameter hole. OFTEC approved and CE marked.



Technical Data

Battery Supplied: Lithium (CR2430)
 Sensor Range: 200 m
 Suitable Application: The unit will easily fit all plastic or steel tanks
 Transmission: 200 m
 Type: Tank Level Monitor

VOLUME FILTER

Rainwater filter for installation inside or on the tank.

The VF1 Combi has the cleaned water outlet at the bottom of the filter. Whilst the dirt is washed away sideways, the bottom cleaned water outlet position makes installing the filter in tanks very easily and practically. Where used before the tank, the Combi gives a high degree of flexibility to the angle of direction of the cleaned water outlet pipe, feeding to the rainwater tank. The VF1 Combi can also be fitted directly to the top surface of the rainwater tank, using a seal we can provide. This means it is acting as a second turret to the tank.

Technical Data

Connection inlet: 2 x DN 100 (110mm OD)
 Outlet into tank: DN 100 (110mm OD)
 Outlet into sewer: DN 100 (110mm OD)
 Housing material: Polyethylene
 Filter cartridge: Stainless steel 1.4301
 Material Cascade insert: Polyethylene
 Weight: 6.2 kg

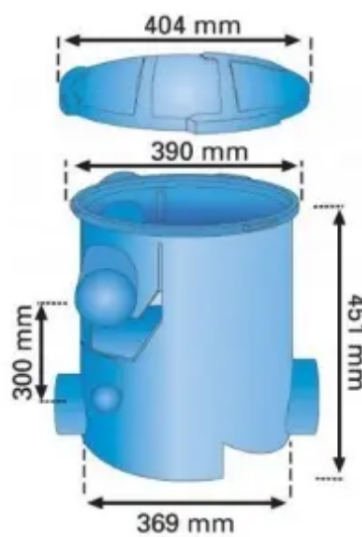

200m2 GARDEN RAINWATER FILTER

A total retention rainwater filter with integrated dirt collecting basket at mesh width of 1 mm.

This filter is highly suitable for garden watering systems and is ideal where no connection to a sewer is possible, or where water is infiltrated.

All inlets and outlets at DN 100 (110mm OD), one inlet can also be used as an emergency overflow. The cleaned rainwater flows through the bottom connection into the rainwater tank. Also a calmed inlet is recommended.

The filter should be cleaned several times during the year, depending on the solid loadings. 2.2 kg

- A total retention rainwater filter with integrated dirt collecting basket
- Easily removable filter basket
- For installation inside a rainwater tank
- Suitable for garden watering
- Ideal where no sewer connection exists
- Designed for roof sizes up to a maximum of 200 sq metres
- Unit weight 2.2 kg

Technical Data

Connection inlet: DN 100 (110mm OD)
 Outlet into rainwater tank: DN 100 (110mm OD)
 Emergency overflow or additional inlet: DN 100 (110mm OD)
 Housing material: Polyethylene
 Material filter basket: Polyethylene Ø 305 x 288 x 245 mm
 Mesh size: 1mm
 Weight: 2.2 kg

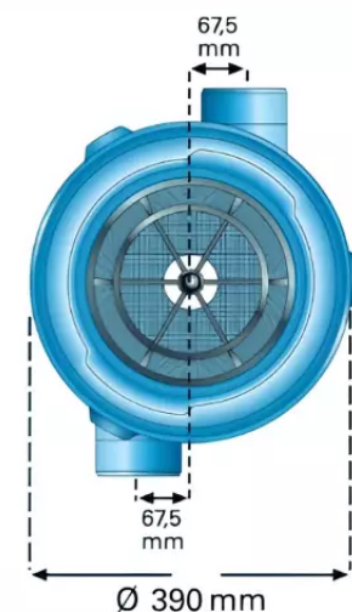
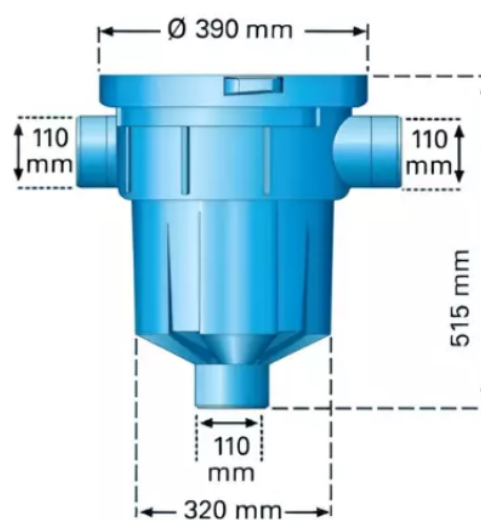

SUBMERSIBLE PUMPS & AIR BLOWERS

We have a range of submersible pumps and air blowers, in various sizes that are ideally used with our systems for maximum efficiency.

- Long life expectancy
- High degree of efficiency
- The oil-free operation guarantees a smooth air flow and no mess.
- Vibration & Noise Free Air Flow
- Robust
- Rainproof and weatherproof

Ideal for use with the Modulus system





SALES & MANUFACTURING HEAD OFFICE

Unit A,
Lakeside Ind Park,
Water Orton,
Birmingham
B46 1NS

Tel No: 01675 432 199

Email: sales@oaklandsenvironmental.com

www.oaklandsenvironmental.com